



# INSTRUCTION BULLETIN

No. 9010958  
Machine: T12  
Published: 08-2013  
Rev. 00

**NOTE: DO NOT DISCARD the Parts List from the Instruction Bulletin. Place the Parts List in the appropriate place in the machine manual for future reference. Retaining the Parts List will make it easier to reorder individual parts and will save the cost of ordering an entire kit.**

*NOTE: Numbers in parenthesis ( ) are reference numbers for parts listed in Bill of Materials.*

Installation instructions for **kit number 9010351**

## SYNOPSIS:

This kit contains the parts needed to install a warning light onto T12 scrubbers equipped with an optional overhead guard.  
Please follow step-by-step instructions.

## SPECIAL TOOLS / CONSIDERATIONS: NONE

(Estimated time to complete: 1.5 hours)



### PROTECT THE ENVIRONMENT

Please dispose of packaging materials, used machine components such as batteries and fluids in an environmentally safe way according to local waste disposal regulations.

Always remember to recycle.

## PREPARATION:

1. Park the machine on a clean level surface, turn off the machine, and remove the key.

**FOR SAFETY: Before leaving or servicing machine, stop on level surface, turn off machine, and remove key.**

2. Disconnect the battery cable from the machine.



**WARNING: Always disconnect battery cables from machine before working on electrical components.**

## INSTALLATION:

1. Insert the rubber grommet (8) into the hole in the overhead guard. (Fig. 1)
2. Route the strobe light (1) wires down through the rubber grommet (8) in the overhead guard. (Fig. 1)
3. Use two M5 pan screws (2), two flat washers (3), and two M5 hex nuts (4) to install the strobe light (1) onto the overhead guard. (Fig. 1)
4. Use two M6 hex screws (6) and two flat washers (7) to install the light guard (5) onto the overhead guard. (Fig. 1)

5. Connect the overhead guard light wire harness (9) to the strobe light (1). (Fig. 1 / Fig. 3 / Fig. 4)
6. Route the overhead guard light wire harness (9) down to the main wire harness and connect the harness to the main harness. (Fig. 1 / Fig. 3 / Fig. 4)
7. Insert two tie clips (11) into the overhead guard. (Fig. 1)
8. Use two cable ties (10) to secure the overhead guard light wire harness (9) to tie clips (11) in the overhead guard (Fig. 1)
9. Use two additional cable ties (10) to secure the overhead guard light wire harness (9) to the overhead guard leg. (Fig. 1)

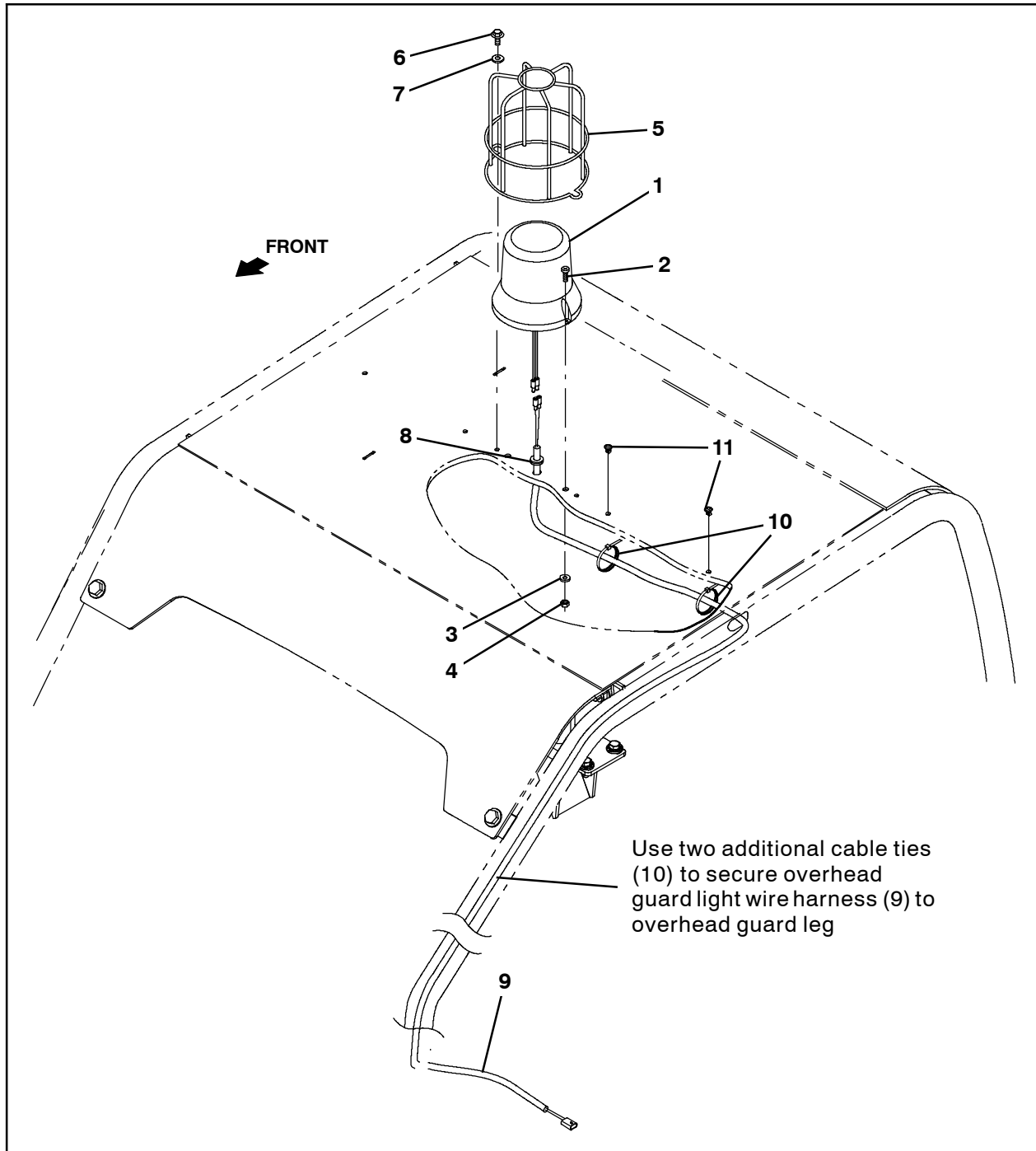
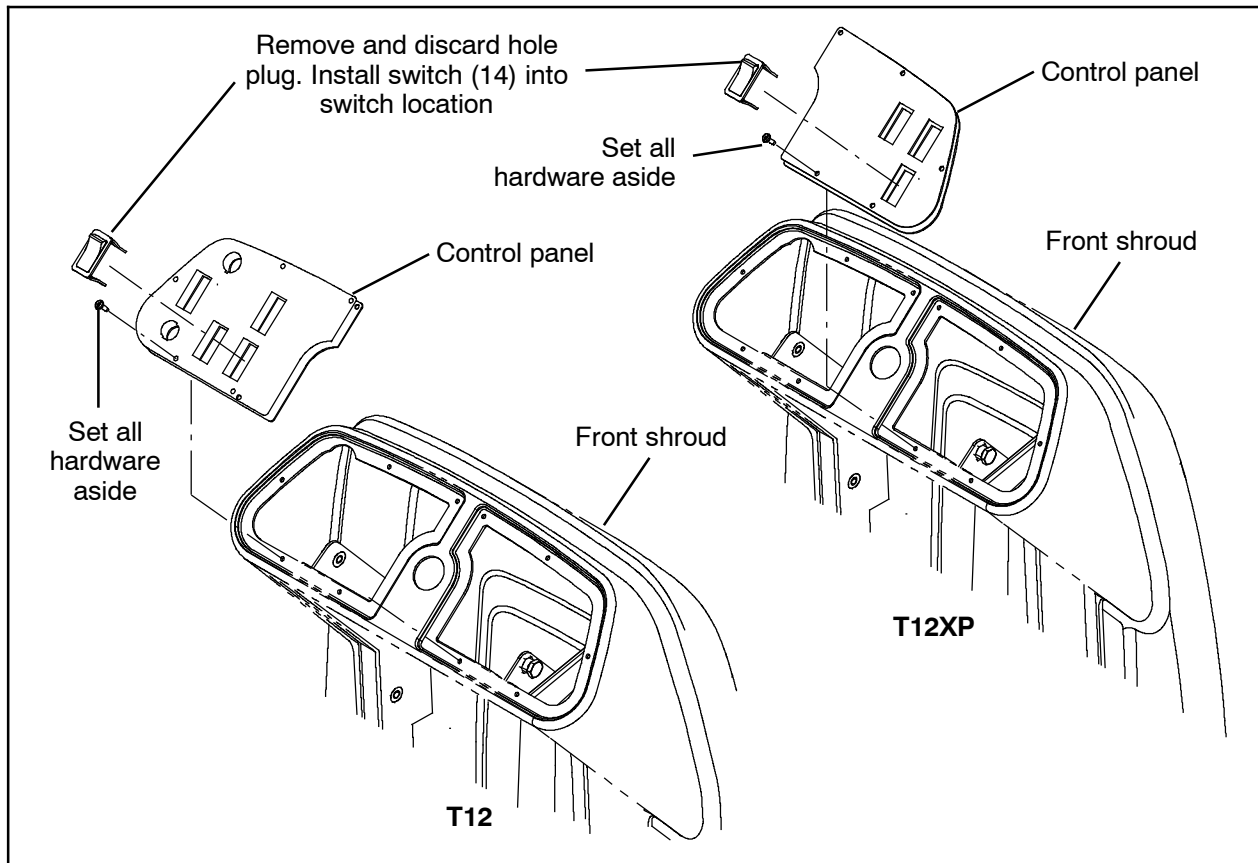

FIG. 1

*NOTE: Complete Step 10 through Step 14 only if machine is not equipped with optional headlights. Proceed to Step 15 if machine is equipped with optional headlights.*

10. Carefully remove the control panel from the machine. Do not break any wire connections. Set the hardware aside. (Fig. 2)
11. Remove the hole plug from the control panel. Discard the hole plug. (Fig. 2)

12. Insert the rocker switch (14) into the control panel where the hole plug was previously located. (Fig. 2)
13. Connect the main wire harness to the rocker switch (12). (Fig. 2 / Fig. 3 / Fig. 4)
14. Reinstall the control panel onto the machine. (Fig. 2)



**FIG. 2**





15. Remove the access panel from the steering channel. (Fig. 5)

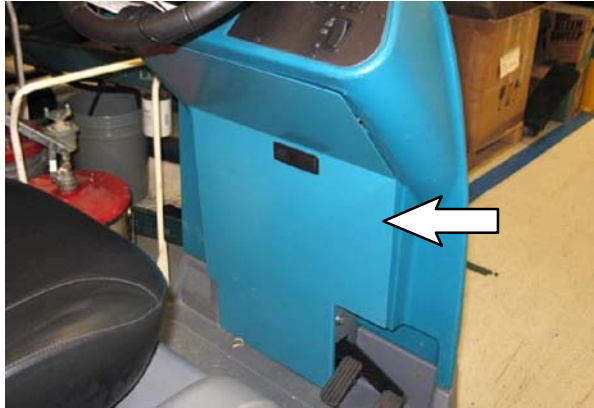

FIG. 5

16. Remove the M8 hex screw securing the bottom of the circuit breaker bracket to the machine. (Fig. 6)

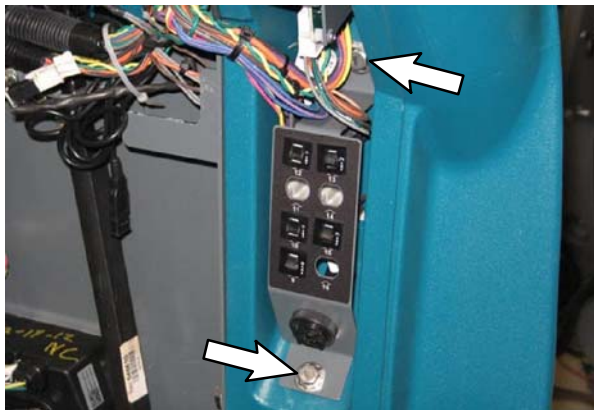

FIG. 6

17. Loosen the M8 hex screw securing the top of the circuit breaker bracket to the machine. (Fig. 6)
18. Pull circuit breaker bracket out far enough to access the main wire harness connectors located behind the bracket. (Fig. 6)

19. **Machines without front light kit option only:** Insert the 15- Amp circuit breaker (13) into circuit breaker location 12 in the circuit breaker bracket. (Fig. 7)

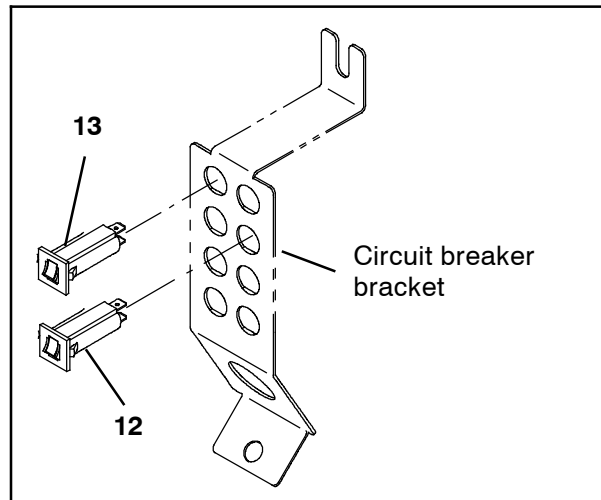

FIG. 7

20. Insert the 2.5 Amp circuit breaker (12) into circuit breaker location 14 in the circuit breaker bracket. (Fig. 7)
21. Connect the main wire harness to the previously installed circuit breaker(s) (12 / 13). (Fig. 7 / Fig. 3 / Fig. 4)
22. Reinstall the M8 hex screw removed from the bottom of the circuit breaker bracket and tighten the M8 hex screw at the top of the circuit breaker bracket. (Fig. 6)
23. Reinstall the access panel onto the steering channel. (Fig. 5)
24. Reconnect the battery cable to the machine.
25. Start and test the machine. Place the light switch into the top position and ensure the strobe light is functioning.

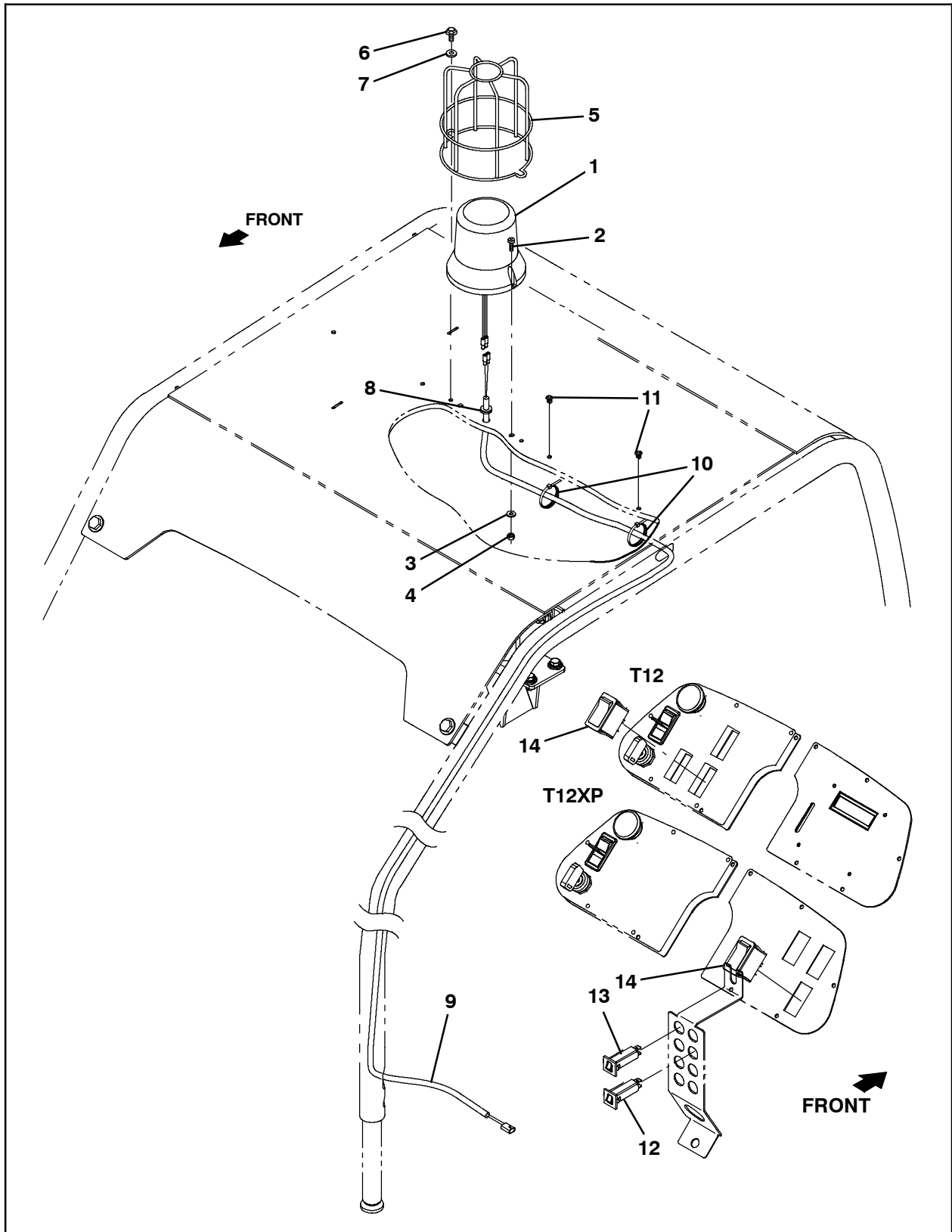

FIG. 8

**Bill Of Materials For Light Kit, Warning, OHG, CI [T12] - 9010351**

	<b>Ref.</b>	<b>Tennant Part No.</b>	<b>Description</b>	<b>Qty.</b>
▽		9010351	Light Kit, Warning, OHG, CI [T12]	1
▲▽	1	1017250	Light, Strobe, Amb, 12- 48VDC	1
▲▲		9000845	Lamp, Bulb, Strobe	1
▲▲		9000879	Lens, Amb, F/ Revl / Flasher	1
▲	2	06933	Screw, Pan, Phl, M5 X 0.80 X 16, 4.8	2
▲	3	19066	Washer, Flat, 0.25b 0.56d .05, Pl, 10	2
▲	4	06549	Nut, Hex, Lock, M5 X 0.80, NI	2
▲	5	1039392	Guard, Light, Revl / Strobe	1
▲	6	74455	Screw, Hex, M6 X 1.00 X 12, Fmg	2
▲	7	32490	Washer, Flat, 0.25, Std	2
▲	8	10632- 2	Grommet, Rbr, 0.62id, F/0.9h, .12 Matl	1
▲	9	1069746	Harness, Ele, OHG [T12]	1
▲	10	49266	Tie, Cable, Nyl, 07.3l, .19w, 1.8 Max. D	4
▲	11	1202868	Clip, Tie, 0.25d, Plstc	2
▲	12	1064184	Circuit Breaker, 02.5a, Resettable	1
▲	13	1064188	Circuit Breaker, 15.0a, Resettable	1
▲	14	377084	Switch, Rocker, Prgrsv	1
		1027798	Lens, Red, F/ Revl / Flasher	1
		1027800	Lens, Blu, F/ Revl / Flasher	1
▲	15	55272	Terminal, Bullet, Mal, .157D, 12Ga	2

TENNANT COMPANY  
P. O. Box 1452  
Minneapolis, MN 55440-1452